

ELEVATION OF WOODEN DOOR - FD10\*  
SCALE - 1:25

- NOTE - 1. ALL OTHER DETAILS SHALL BE AS PER TD - CEV2/2022/TD-04
2. ALL FITTINGS & FIXTURES FOR FD10\* SHALL BE OF USER FRIENDLY FOR DISABLED PEOPLE.
3. MORTISE LOCK AT HT 800 SHALL BE PROVIDED IN LIEU OF ALL LOCKING ARRANGEMENTS SHOWN IN TD.

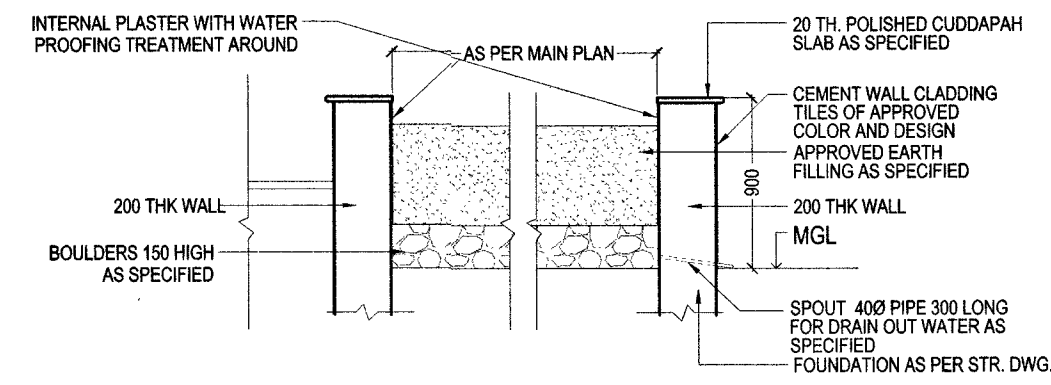

DETAIL OF LANDSCAPE AREA  
SCALE - 1:25

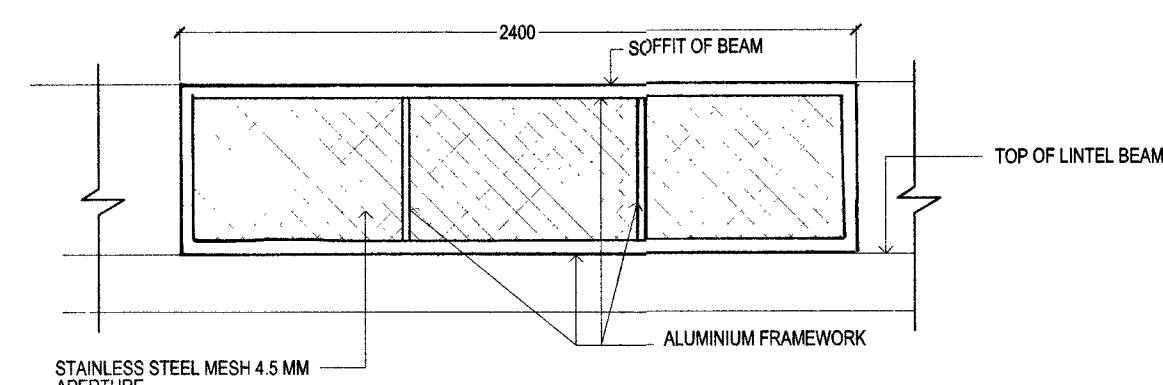

DETAIL OF MOSQUITO PROOF JALI (ALV 24)  
SCALE - 1:25

- NOTE - 1. ALL OTHER DETAILS SHALL BE AS PER TD - CEV2/2022/TD - 13, SHT 1/4 - 4/4

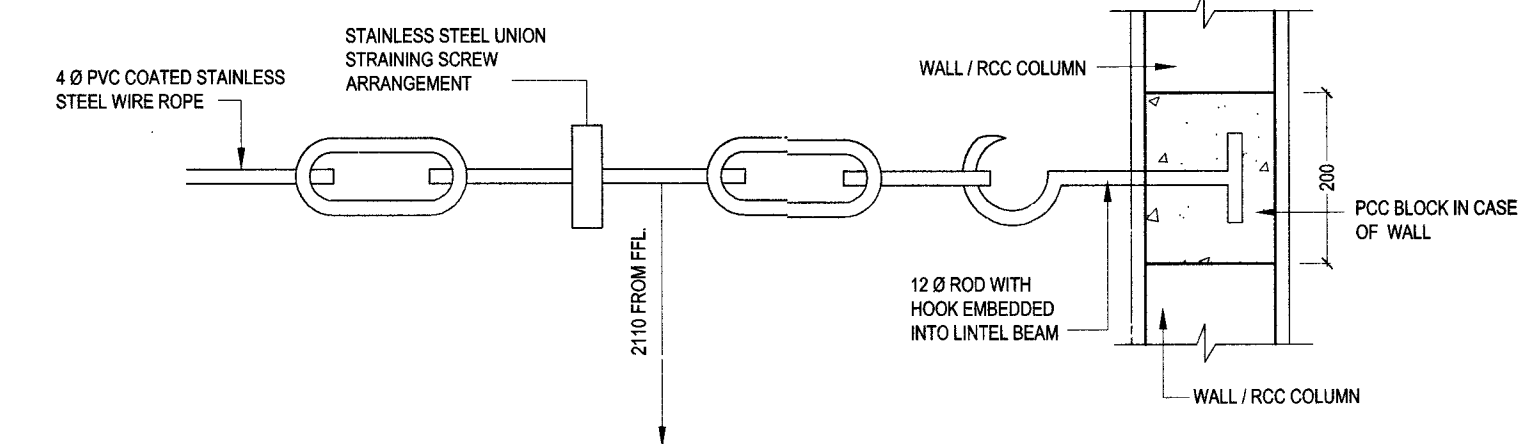

FIXING DETAIL OF STAINLESS STEEL CEILING MOUNTED CLOTH DRYING RAILERS  
SCALE 1:25

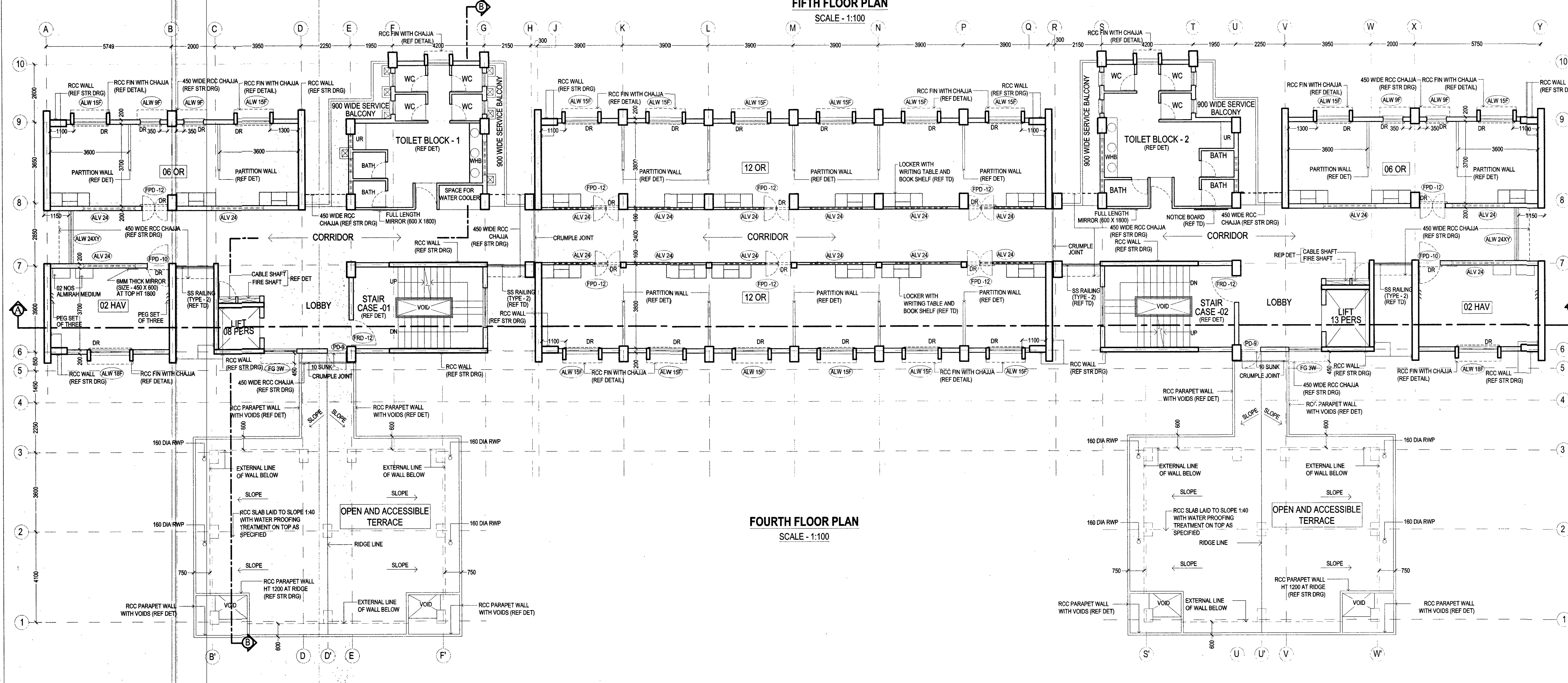
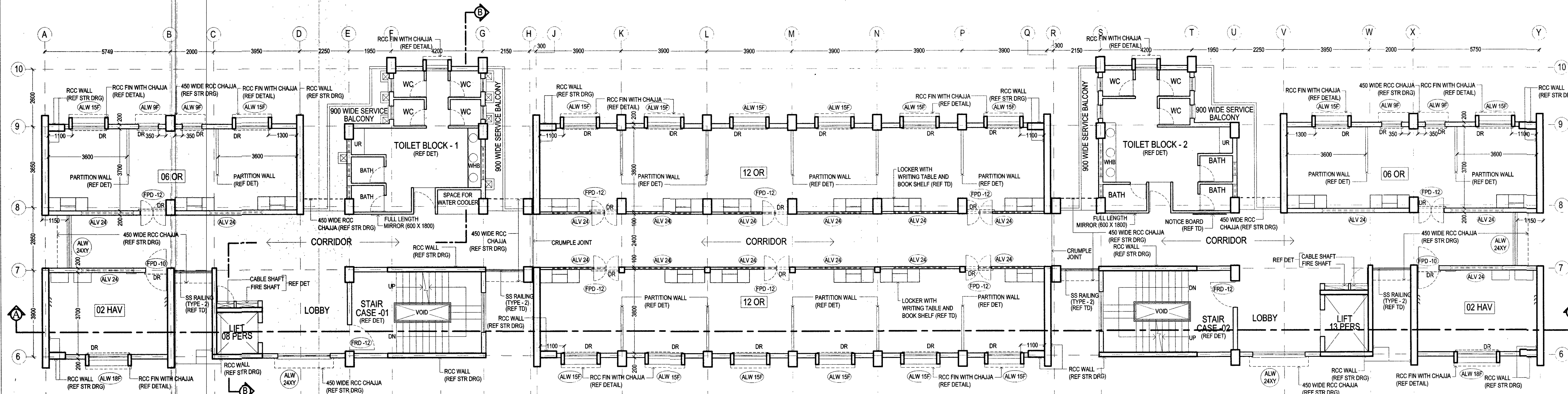

SL NO	DATE	DESCRIPTION	INITIAL
REVISIONS			
6	21 OCT 2022	PROVISION OF DEFICIENT 287 SINGLE INLIVING ACCN ASSOCIATED FACILITIES FOR DSC AT NAVAL DOCKYARD, VISAKHAPATNAM (BD NO AMWP 46/2020)	
5			
4			
3			
2			
1			

DATE	21 OCT 2022	CHIEF ENGINEER (NAVY)	SHEET NO
DRN	SUVRO	VISAKHAPATNAM ZONE	4R / 24
TCD			
CKD			
SCALE	AS SHOWN	REF DRG. NO. CEV2/2022/WD-2110 (SA-CH/DH)	

K. Sivan	AAD (ARCH)	
J. Sivan	JT DIR (ARCH)	
	DIR (ARCH) FOR CHIEF ENGINEER	